

SALES REPORT

HIGHBURY 5089

Sales Map

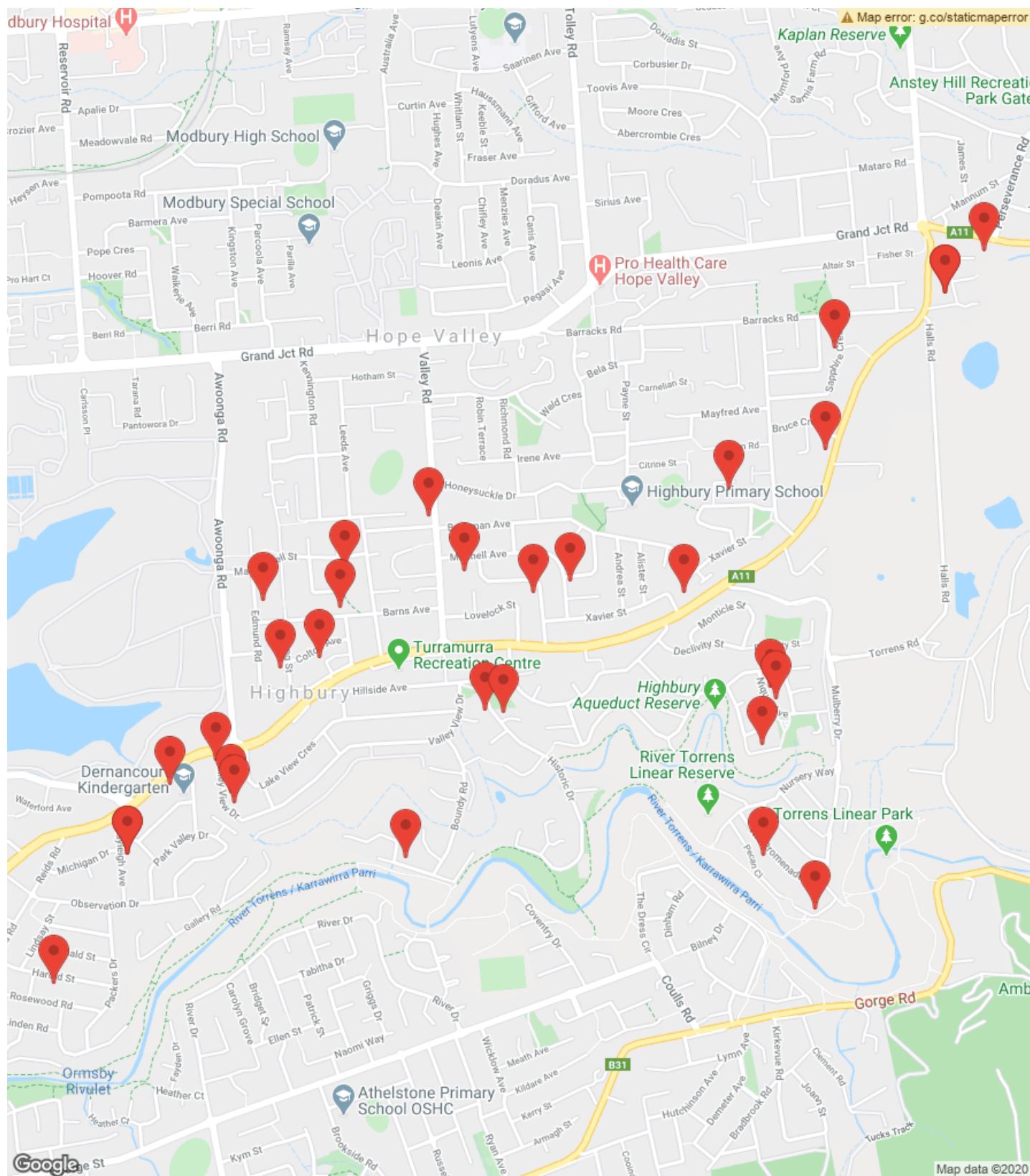

Sales Search Report - Image Report

Search Criteria

Locality: HIGHBURY
Postcode: 5089

Sale Date: 01/05/2020 to 03/08/2020

Sale Price: Any

Land Size: Any

Attributes: Any

Property Type: Any

Search Summary

Records: 37

	Price	Days	Area
Lowest	\$ 0	20	293 m ²
Highest	\$ 1,422,000	393	6,660 m ²
Average	\$ 437,257	114	972 m ²
Median	\$ 450,000	78	690 m ²



1113 LOWER NORTH EAST RD, HIGHBURY, SA 5089

UBD Ref: Adelaide - 97 A9 - - -



Property Type: Other
Area: 6,660 m²
Area \$/m2: \$0
RPD: A102//D60639

Features:

Sale Price: \$0 (Agents Advice - Sale)
Sale Date: 24/07/2020 **Days to Sell:** 230 Days
Last Price: PRICE REDUCED **Chg %:**
First Price: \$235,000 (Under Offer) **Chg %:**



24 SAPPHIRE CRES, HIGHBURY, SA 5089

UBD Ref: Adelaide - 97 C5 4 2 3



Property Type: House
Area: 585 m² (122 m²)
Area \$/m2: \$915(\$4,385)
RPD: AL16//D9319

Features: BUILD YR: 1972, WALL TYPE: BRICK, ROOF TYPE: TILED (TERRA COTTA OR CEMENT), STYLE: RANCH, STOREYS: 1

Sale Price: \$535,000 (Normal Sale)
Sale Date: 20/07/2020 **Days to Sell:** 130 Days
Last Price: Contact Agent (Under **Chg %:**
First Price: \$535,000-\$555,000 **Chg %:**



43 THE PROM, HIGHBURY, SA 5089

UBD Ref: Adelaide - 97 C13 - - -

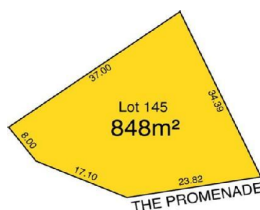

Property Type: Vacant Land
Area: 848 m²
Area \$/m2: \$684
RPD: AL145//D54599

Features: STOREYS: 1

Sale Price: \$580,000 (Normal Sale)
Sale Date: 17/07/2020 **Days to Sell:** N/A
Last Price: **Chg %:**
First Price: **Chg %:**



11 THE PROM, HIGHBURY, SA 5089

UBD Ref: Adelaide - 97 B12 4 2 2



Property Type: House
Area: 4,284 m²
Area \$/m2: \$332
RPD: AL1//D76438

Features: WALL TYPE: STONE; FREESTONE, ROOF TYPE: GALVANISED IRON, STYLE: RETURN VERANDAH VILLA, STOREYS: 2

Sale Price: \$1,422,000 (Normal Sale)
Sale Date: 17/07/2020 **Days to Sell:** 239 Days
Last Price: \$1,500,000 - \$1,590,000 **Chg %:** -5.2%
First Price: Contact Agent **Chg %:** -28.9%

2 KINNAIRD CRES, HIGHBURY, SA 5089

UBD Ref: Adelaide - 97 E5



Property Type: Vacant Land
Area: 503 m²
Area \$/m2: \$517
RPD: AL1//D118872

Features: STOREYS: 1

Sale Price: \$260,000 (Normal Sale)

Sale Date: 17/07/2020 **Days to Sell:** N/A

Last Price: Chg %:

First Price: Chg %:

DORDOY ST, HIGHBURY, SA 5089

Photo not available

Property Type: Vacant Land
Area: 307 m²
Area \$/m2: \$713
RPD: AL3//D123284

Features: STOREYS: 1

Sale Price: \$219,000 (Normal Sale)

Sale Date: 17/07/2020 **Days to Sell:** N/A

Last Price: Chg %:

First Price: Chg %:

17 HAROLD ST, HIGHBURY, SA 5089

UBD Ref: Adelaide - 96 H14



Property Type: House
Area: 722 m² (116 m²)
Area \$/m2:
RPD: A26//D6699

Features: BUILD YR: 1966, WALL TYPE: BRICK, ROOF TYPE: TILED (TERRA COTTA OR CEMENT), STYLE: CONVENTIONAL, STOREYS: 1

Sale Price: Price Withheld (Agents Advice - Sale)

Sale Date: 14/07/2020 **Days to Sell:** 20 Days

Last Price: \$449,000 to \$479,000 Chg %:

First Price: \$449,000 to \$479,000 Chg %:

4 LAKE VIEW CRES, HIGHBURY, SA 5089

Photo not available

Property Type: Vacant Land
Area: 497 m²
Area \$/m2: \$0
RPD: AL300//D123663

Features: STOREYS: 1

Sale Price: \$0 (No Consideration)

Sale Date: 13/07/2020 **Days to Sell:** N/A

Last Price: Chg %:

First Price: Chg %:

4 LAKE VIEW CRES, HIGHBURY, SA 5089

Photo not available

Property Type: Vacant Land
Area: 410 m²
Area \$/m2: \$0
RPD: AL301//D123663

Features: STOREYS: 1

Sale Price: \$0 (No Consideration)

Sale Date: 13/07/2020 **Days to Sell:** N/A

Last Price: Chg %:

First Price: Chg %:

DORDOY ST, Highbury, SA 5089

- - -



Photo not available

Property Type: Vacant Land
Area: 353 m²
Area \$/m2: \$708
RPD: AL1//D123284

Features: STOREYS: 1

Sale Price: \$250,000 (Normal Sale)
Sale Date: 10/07/2020 **Days to Sell:** N/A
Last Price: Chg %:
First Price: Chg %:

20 BRADSHAW AVE, Highbury, SA 5089

UBD Ref: Adelaide - 96 N8 2 1 1



Property Type: Unit
Area: 408 m² (98 m²)
Area \$/m2: \$773(\$3,214)
RPD: UN2//S2244

Features: BUILD YR: 1975, WALL TYPE: BRICK, ROOF TYPE: TILED (TERRA COTTA OR CEMENT), STYLE: RANCH, STOREYS: 1

Sale Price: \$315,000 (Normal Sale)
Sale Date: 26/06/2020 **Days to Sell:** 87 Days
Last Price: \$329,000 Chg %: -4.3%
First Price: \$329,000 - \$339,000 Chg %: -4.3%

10 LINEAR PARK DR, Highbury, SA 5089

UBD Ref: Adelaide - 96 M13 5 2 2



Property Type: House
Area: 774 m² (313 m²)
Area \$/m2: \$1,059(\$2,620)
RPD: AL25//D40996

Features: BUILD YR: 1995, WALL TYPE: BRICK, ROOF TYPE: TILED (TERRA COTTA OR CEMENT), STYLE: CONVENTIONAL, STOREYS: 2

Sale Price: \$820,000 (Normal Sale)
Sale Date: 25/06/2020 **Days to Sell:** N/A
Last Price: Chg %:
First Price: Chg %:

2 KINNAIRD CRES, Highbury, SA 5089

- - -

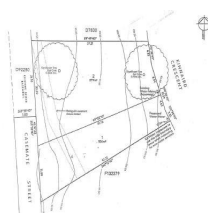

Property Type: Vacant Land
Area: 1,342 m² (186 m²)
Area \$/m2: \$194(\$1,398)
RPD: A1//D118872

Features: BUILD YR: 1975, WALL TYPE: BRICK, ROOF TYPE: TILED (TERRA COTTA OR CEMENT), STYLE: RANCH, STOREYS: 1

Sale Price: \$260,000 (Agents Advice - Sale)
Sale Date: 24/06/2020 **Days to Sell:** N/A
Last Price: Chg %:
First Price: Chg %:

6 HISTORIC DR, Highbury, SA 5089

UBD Ref: Adelaide - 96 N10 5 3 1



Property Type: House
Area: 642 m² (236 m²)
Area \$/m2: \$0(\$0)
RPD: AL6//D24042

Features: BUILD YR: 1990, WALL TYPE: BRICK, ROOF TYPE: TILED (TERRA COTTA OR CEMENT), STYLE: CAPE COD, STOREYS: 1

Sale Price: \$0 (No Consideration)
Sale Date: 19/06/2020 **Days to Sell:** N/A
Last Price: Chg %:
First Price: Chg %:

10 VALLEY VIEW DR, Highbury, SA 5089

UBD Ref: Adelaide - 96 K12 4 2 1



Property Type: House
 Area: 772 m²
 Area \$/m²: \$700
 RPD: A45//D6131

Features:

Sale Price: **\$540,500 (Agents Advice - Sale)**
 Sale Date: 19/06/2020 Days to Sell: **45 Days**
 Last Price: UNDER CONTRACT Chg %:
 First Price: \$495,000 - \$540,000 Chg %:

18 FRESHFORD AVE, Highbury, SA 5089

UBD Ref: Adelaide - 97 B11 5 3 3



Property Type: House
 Area: 911 m² (322 m²)
 Area \$/m²: \$870(\$2,463)
 RPD: AL82//D10982

Features: BUILD YR: 1986, WALL TYPE: BRICK, ROOF TYPE: TILED (TERRA COTTA OR CEMENT), STYLE: COLONIAL, STOREYS: 1

Sale Price: **\$793,000 (Normal Sale)**
 Sale Date: 17/06/2020 Days to Sell: **87 Days**
 Last Price: Contact agent (Under Chg %: **-4.5%**
 First Price: \$920,000 - \$950,000 Chg %: **-13.8%**

13 RAYLEIGH AVE, Highbury, SA 5089

UBD Ref: Adelaide - 96 J13 3 1 -



Property Type: House
 Area: 676 m² (173 m²)
 Area \$/m²: \$0(\$0)
 RPD: AL104//D6462

Features:

Sale Price: **\$0 (No Consideration)**
 Sale Date: 15/06/2020 Days to Sell: **N/A**
 Last Price: Chg %:
 First Price: Chg %:

12 GARNET CRT, Highbury, SA 5089

UBD Ref: Adelaide - 97 B7 4 2 3



Property Type: House
 Area: 600 m² (199 m²)
 Area \$/m²: \$900(\$2,714)
 RPD: AL3//D17449

Features: BUILD YR: 1989, WALL TYPE: BRICK, ROOF TYPE: TILED (TERRA COTTA OR CEMENT), STYLE: CONVENTIONAL, STOREYS: 2

Sale Price: **\$540,000 (Normal Sale)**
 Sale Date: 12/06/2020 Days to Sell: **211 Days**
 Last Price: \$560k Chg %:
 First Price: \$560k Chg %:

4 LANG ST, Highbury, SA 5089

UBD Ref: Adelaide - 96 L10 3 1 7



Property Type: House
 Area: 911 m² (128 m²)
 Area \$/m²: \$486(\$3,461)
 RPD: AL55//D6045

Features: BUILD YR: 1967, WALL TYPE: BRICK, ROOF TYPE: TILED (TERRA COTTA OR CEMENT), STYLE: CONVENTIONAL, STOREYS: 1

Sale Price: **\$443,000 (Normal Sale)**
 Sale Date: 11/06/2020 Days to Sell: **78 Days**
 Last Price: \$445,000 - \$465,000 Chg %: **-0.4%**
 First Price: \$445,000-\$465,000 Chg %: **-0.4%**

22 KINNAIRD CRES, HIGHBURY, SA 5089

UBD Ref: Adelaide - 97 E4 4 2 2



Property Type: House
 Area: 1,400 m² (199 m²)
 Area \$/m²: \$375(\$2,638)
 RPD: AL12//D7830

Sale Price: **\$525,000 (Normal Sale)**
 Sale Date: 09/06/2020 Days to Sell: **103 Days**
 Last Price: \$499,000 - \$545,000 Chg %:
 First Price: \$549,000 Chg %: **-4.4%**

Features: BUILD YR: 1973, WALL TYPE: BRICK, ROOF TYPE: CORRUGATED CEMENT SHEET, STYLE: HIGH QUALITY CONTEMPORARY, STOREYS: 1

BARNS AVE, HIGHBURY, SA 5089

- - -

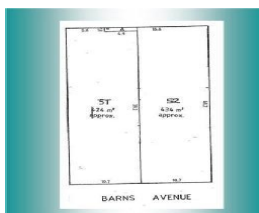

Property Type: Vacant Land
 Area:
 Area \$/m²:
 RPD:

Sale Price: **Price Withheld (Agents Advice - Sale)**
 Sale Date: 01/06/2020 Days to Sell: **362 Days**
 Last Price: \$255,000 - \$265,000 Chg %:
 First Price: \$290,000 - \$300,000 Chg %:

Features:

BARNS AVE, HIGHBURY, SA 5089

- - -

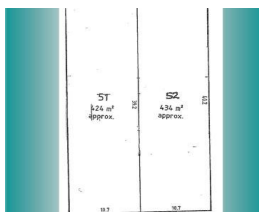

Property Type: Other
 Area:
 Area \$/m²:
 RPD:

Sale Price: **\$0 (Agents Advice - Sale)**
 Sale Date: 01/06/2020 Days to Sell: **96 Days**
 Last Price: \$255,000 - \$265,000 Chg %:
 First Price: \$265,000 - \$275,000 Chg %:

Features:

36 BRISTOL CRES, HIGHBURY, SA 5089

UBD Ref: Adelaide - 96 L9 4 1 2



Property Type: House
 Area: 381 m² (142 m²)
 Area \$/m²: \$1,050(\$2,817)
 RPD: AL74//D83472

Sale Price: **\$400,000 (Normal Sale)**
 Sale Date: 29/05/2020 Days to Sell: **72 Days**
 Last Price: \$415,000 - \$425,000 Chg %: **-3.6%**
 First Price: \$415,000-\$425,000 Chg %: **-3.6%**

Features: BUILD YR: 2010, WALL TYPE: BRICK, ROOF TYPE: GALVANISED IRON, STYLE: CONVENTIONAL, STOREYS: 1

1183 LOWER NORTH EAST RD, HIGHBURY, SA 5089

UBD Ref: Adelaide - 97 C7 2 1 1



Property Type: House
 Area: 427 m² (90 m²)
 Area \$/m²: \$703(\$3,333)
 RPD: FL180//C25846

Sale Price: **\$300,000 (Normal Sale)**
 Sale Date: 29/05/2020 Days to Sell: **71 Days**
 Last Price: \$299,000 - \$309,000 Chg %:
 First Price: \$299,000 - \$309,000 Chg %:

Features: BUILD YR: 1950, WALL TYPE: BRICK, ROOF TYPE: TILED (TERRA COTTA OR CEMENT), STYLE: AUSTERITY, STOREYS: 1

6 NIQUET AVE, Highbury, SA 5089

UBD Ref: Adelaide - 97 B10 3 2 2



Property Type: House
Area: 690 m² (164 m²)
Area \$/m²: \$768(\$3,232)
RPD: AL64//D11081

Sale Price: **\$530,000 (Normal Sale)**
Sale Date: 28/05/2020 **Days to Sell:** 65 Days
Last Price: \$520k-\$560k **Chg %:**
First Price: \$520k-\$560k (Under **Chg %:**

Features: BUILD YR: 1984, WALL TYPE: BRICK, ROOF TYPE: TILED (TERRA COTTA OR CEMENT), STYLE: HIGH QUALITY CONTEMPORARY, STOREYS: 1

37 EDMUND RD, Highbury, SA 5089

UBD Ref: Adelaide - 96 K9 3 1 8



Property Type: House
Area: 809 m² (260 m²)
Area \$/m²: \$516(\$1,606)
RPD: AL67//D6182

Sale Price: **\$417,500 (Normal Sale)**
Sale Date: 28/05/2020 **Days to Sell:** 65 Days
Last Price: \$398,000 - \$437,000 **Chg %:**
First Price: \$398,000 - \$437,000 **Chg %:**

Features: BUILD YR: 1969, WALL TYPE: BRICK, ROOF TYPE: TILED (TERRA COTTA OR CEMENT), STYLE: CONVENTIONAL, STOREYS: 1

16 BARNES AVE, Highbury, SA 5089

UBD Ref: Adelaide - 96 L9 3 1 4



Property Type: House
Area: 754 m² (125 m²)
Area \$/m²: \$597(\$3,600)
RPD: AL36//D6045

Sale Price: **\$450,000 (Normal Sale)**
Sale Date: 27/05/2020 **Days to Sell:** 39 Days
Last Price: \$445,000- \$455,000 **Chg %:**
First Price: \$445,000- \$455,000 **Chg %:**

Features: BUILD YR: 1970, WALL TYPE: BRICK, ROOF TYPE: TILED (TERRA COTTA OR CEMENT), STYLE: CONVENTIONAL, STOREYS: 1

13 RAYLEIGH AVE, Highbury, SA 5089

UBD Ref: Adelaide - 96 J13 3 1 -



Property Type: House
Area: 676 m² (173 m²)
Area \$/m²: \$666(\$2,601)
RPD: AL104//D6462

Sale Price: **\$450,000 (Normal Sale)**
Sale Date: 25/05/2020 **Days to Sell:** N/A
Last Price: **Chg %:**
First Price: **Chg %:**

Features: BUILD YR: 1964, WALL TYPE: BRICK, ROOF TYPE: TILED (TERRA COTTA OR CEMENT), STYLE: CONVENTIONAL, STOREYS: 1

12 Highbury DR, Highbury, SA 5089

UBD Ref: Adelaide - 96 P9 3 2 2



Property Type: House
Area: 381 m² (203 m²)
Area \$/m²: \$1,654(\$3,103)
RPD: AL101//D12072

Sale Price: **\$630,000 (Normal Sale)**
Sale Date: 25/05/2020 **Days to Sell:** 34 Days
Last Price: Contact Agent **Chg %:**
First Price: Contact Agent **Chg %:**

Features: BUILD YR: 2018, WALL TYPE: BRICK, ROOF TYPE: COLOURBOND, STYLE: CONVENTIONAL, STOREYS: 1

14 VALLEY VIEW DR, Highbury, SA 5089

UBD Ref: Adelaide - 96 K12 4 1 2



Property Type: House
 Area: 988 m² (137 m²)
 Area \$/m²: \$534(\$3,854)
 RPD: AL43//D6131

Sale Price: **\$528,000 (Normal Sale)**
 Sale Date: 22/05/2020 Days to Sell: **393 Days**
 Last Price: UNDER CONTRACT Chg %:
 First Price: \$605,000 \$605,000 Chg %: **-12.7%**

Features: BUILD YR: 1970, WALL TYPE: BRICK, ROOF TYPE: TILED (TERRA COTTA OR CEMENT), STYLE: CONVENTIONAL, STOREYS: 1

3/32 Highbury Dr, Highbury, SA 5089

UBD Ref: Adelaide - 96 N9 - - -



Property Type: House
 Area: 293 m²
 Area \$/m²: \$1,724
 RPD: FL903//C41756

Sale Price: **\$505,000 (Normal Sale)**
 Sale Date: 20/05/2020 Days to Sell: **N/A**
 Last Price: Chg %:
 First Price: Chg %:

Features: STOREYS: 1

946 LOWER NORTH EAST RD, Highbury, SA 5089

UBD Ref: Adelaide - 96 K11 4 1 5



Property Type: House
 Area: 922 m² (87 m²)
 Area \$/m²: \$488(\$5,172)
 RPD: AL74//D6131

Sale Price: **\$450,000 (Normal Sale)**
 Sale Date: 14/05/2020 Days to Sell: **44 Days**
 Last Price: UNDER CONTRACT by Chg %:
 First Price: TENDER offers close Chg %:

Features: BUILD YR: 1955, WALL TYPE: CEMENT SHEET; WEATHERBRD; LOG, ROOF TYPE: STEEL DECKING, STYLE: CONTEMPORARY, STOREYS: 1

7 COLTON AVE, Highbury, SA 5089

UBD Ref: Adelaide - 96 L10 4 2 1



Property Type: House
 Area: 780 m² (174 m²)
 Area \$/m²: \$768(\$3,443)
 RPD: AL67//D6045

Sale Price: **\$599,000 (Normal Sale)**
 Sale Date: 12/05/2020 Days to Sell: **84 Days**
 Last Price: \$599-649,000 Chg %:
 First Price: \$599-649,000 (Under Chg %:

Features: BUILD YR: 1978, WALL TYPE: BRICK, ROOF TYPE: TILED (TERRA COTTA OR CEMENT), STYLE: CONVENTIONAL, STOREYS: 1

10 NIQUET AVE, Highbury, SA 5089

UBD Ref: Adelaide - 97 B10 3 2 2



Property Type: House
 Area: 690 m² (180 m²)
 Area \$/m²: \$925(\$3,544)
 RPD: AL66//D11081

Sale Price: **\$638,000 (Normal Sale)**
 Sale Date: 05/05/2020 Days to Sell: **61 Days**
 Last Price: Contact Agent Chg %:
 First Price: \$580,000 - \$620,000 Chg %:

Features: BUILD YR: 1986, WALL TYPE: BRICK, ROOF TYPE: TILED (TERRA COTTA OR CEMENT), STYLE: HIGH QUALITY CONVENTIONAL, STOREYS: 1

3 HISTORIC DR, HIGHBURY, SA 5089

UBD Ref: Adelaide - 96 P11

4

3

3

Property Type: House
Area: 1,060 m² (440 m²)
Area \$/m²: \$1,132(\$2,727)
RPD: AL702//D76129

Sale Price: \$1,200,000 (Normal Sale)
Sale Date: 01/05/2020 **Days to Sell:** 56 Days
Last Price: Under Contract - Scott **Chg %:**
First Price: Contact Agent (Under **Chg %:**

Features: BUILD YR: 2009, WALL TYPE: RENDERED, ROOF TYPE: GALVANISED IRON, STYLE: CONVENTIONAL, STOREYS: 1

1 DUNCAN CRES, HIGHBURY, SA 5089

UBD Ref: Adelaide - 96 P9

3

1

1

Property Type: House
Area: 399 m² (106 m²)
Area \$/m²: \$860(\$3,236)
RPD: AL200//D114248

Sale Price: \$343,000 (Normal Sale)
Sale Date: 01/05/2020 **Days to Sell:** 92 Days
Last Price: \$349,000 - \$369,000 **Chg %:** -1.7%
First Price: \$349,000 - \$369,000 **Chg %:** -1.7%

Features: BUILD YR: 1971, WALL TYPE: BRICK, ROOF TYPE: TILED (TERRA COTTA OR CEMENT), STYLE: CONVENTIONAL, STOREYS: 1

926 LOWER NORTH EAST RD, HIGHBURY, SA 5089

UBD Ref: Adelaide - 96 J12

4

2

2

Property Type: House
Area: 1,148 m² (239 m²)
Area \$/m²: \$455(\$2,186)
RPD: AL1//F132303

Sale Price: \$522,500 (Normal Sale)
Sale Date: 01/05/2020 **Days to Sell:** 74 Days
Last Price: \$580,000 to \$620,000 **Chg %:** -9.9%
First Price: Auction **Chg %:**

Features: BUILD YR: 1970, WALL TYPE: BRICK, ROOF TYPE: TILED (TERRA COTTA OR CEMENT), STYLE: HIGH QUALITY CONTEMPORARY, STOREYS: 1